

LOCATION, LOCATION, LOCATION

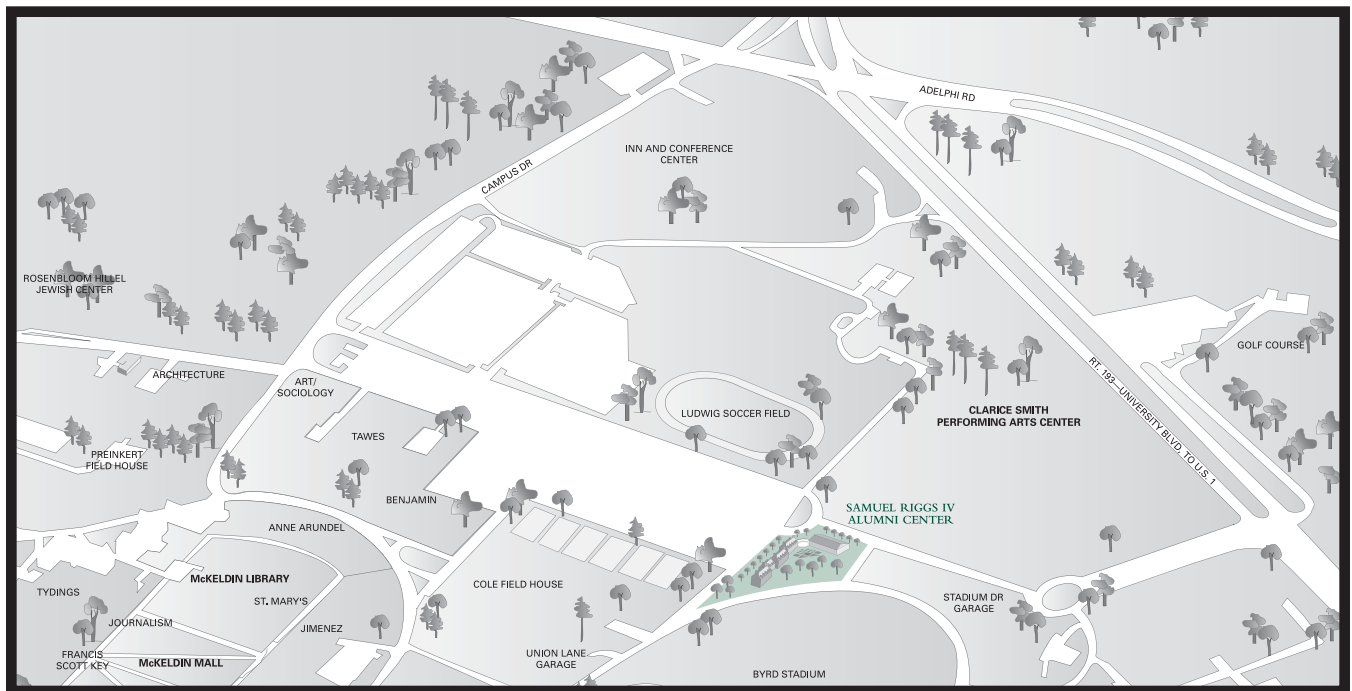

THE SAMUEL RIGGS IV ALUMNI CENTER is situated on the University of Maryland, College Park, campus—conveniently located off of I-495 and close to the College Park Metro Station. The center is at the hub of the university's northwest corner next to the Clarice Smith Performing Arts Center and Byrd Stadium.

For driving directions, please see reverse side.

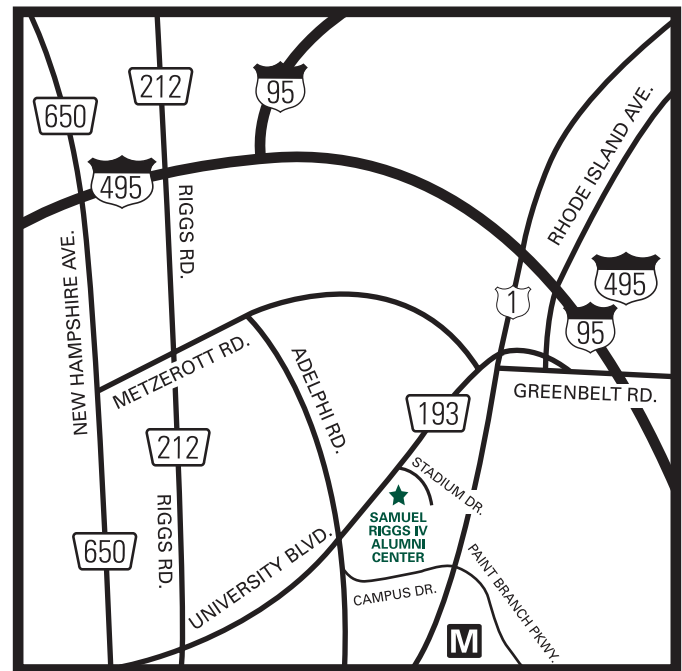

SAMUEL RIGGS IV ALUMNI CENTER

301.405.9756/800.336.8627 ■ riggsinfo@ur.umd.edu ■ www.riggs.umd.edu

DRIVING DIRECTIONS

FROM BALTIMORE AND POINTS NORTH:

Take I-95 South to the Capital Beltway, exit 27, and immediately follow signs to exit 25B—College Park/U.S. Route 1 South. After proceeding on Route 1 approximately two miles, take a right-hand exit onto Route 193 West. Go two traffic lights to Stadium Drive. Make a left onto Stadium Drive. Continue on Stadium Drive, bearing right at the traffic circle. The Samuel Riggs IV Alumni Center is on the left just beyond Byrd Stadium.

FROM BALTIMORE/WASHINGTON INTERNATIONAL/THURGOOD MARSHALL AIRPORT:

Take 195 West to I-95 South. Take I-95 South to the Capital Beltway, exit 27, and immediately follow signs to exit 25B—College Park/U.S. Route 1 South. After proceeding on Route 1 approximately two miles, take a right-hand exit onto Route 193 West. Go two traffic lights to Stadium Drive. Make a left onto Stadium Drive. Continue on Stadium Drive, bearing right at the traffic circle. The Samuel Riggs IV Alumni Center is on the left just beyond Byrd Stadium.

FROM REAGAN NATIONAL AIRPORT:

Take I-395 North until it terminates at New York Ave. Make a right onto New York Ave., and exit at Maryland Route 295 North (Baltimore/Washington Parkway). Exit at Maryland Route 193 West (Greenbelt Road) and follow straight for three miles to Stadium Drive. Make a left onto Stadium Drive. Continue on Stadium Drive, bearing right at the traffic circle. The Samuel Riggs IV Alumni Center is on the left just beyond Byrd Stadium.

FROM WASHINGTON/RICHMOND AND POINTS SOUTH:

Take I-95 North to exit 23 (MD 201-Kenilworth Ave.) from the Capital Beltway south to MD 193 and turn right (westbound). Cross under U.S. Route 1 and turn left at light onto Stadium Drive. Continue on Stadium Drive, bearing right at the traffic circle. The Samuel Riggs IV Alumni Center is on the left just beyond Byrd Stadium.

FROM DULLES INTERNATIONAL AIRPORT AND POINTS WEST:

Take the Dulles Toll Road to I-495 North. Take I-495 North (Washington Beltway) for approximately 25 minutes to exit 25B. Take I-95 South to the Capital Beltway, exit 27, and immediately follow signs to exit 25B—College Park/U.S. Route 1 South. After proceeding on Route 1 approximately two miles, take a right-hand exit onto Route 193 West. Go two traffic lights to Stadium Drive. Make a left onto Stadium Drive. Continue on Stadium Drive, bearing right at the traffic circle. The Samuel Riggs IV Alumni Center is on the left just beyond Byrd Stadium.